

APEX™ SERIES DESK

Rectangle Desk (36" x 20")

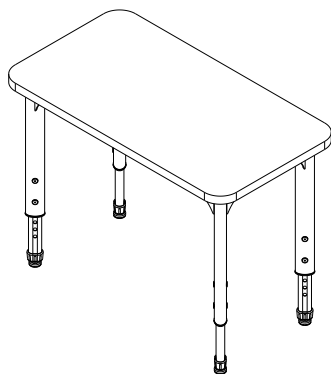

CONSTRUCTION

- Top constructed of 1-1/8" particleboard with thermally fused melamine surface on both sides
- Thermally fused 3mm PVC edge banding
- Pre-drilled holes for easy leg assembly
- Four 16-gauge steel legs mounted on a 12-gauge steel plate, fully coated with powder coat finish
- Lower legs constructed of 16-gauge steel with powder coat finish, tapped at 1" intervals for adjustment
- Nickel plated nylon swivel glides standard

FINISHES

LAMINATES Available with matching or colored edge band



DRY ERASE LAMINATES Available with colored edge band

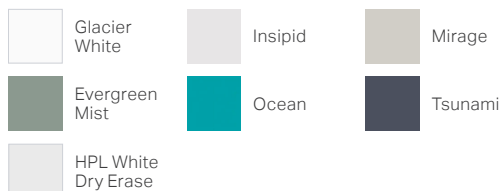

OPTIONAL EDGE BAND COLORS

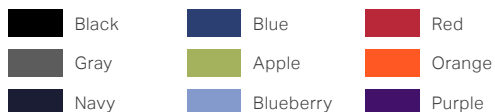

METAL FRAME OPTIONS



DIMENSIONS

Model #	Width	Depth	Height	Weight	Freight Cts
38-2220-Axxx	36"	20"	21" - 30"	50 lbs	92.5
38-2220-Bxxx	36"	20"	17" - 24"	45 lbs	92.5

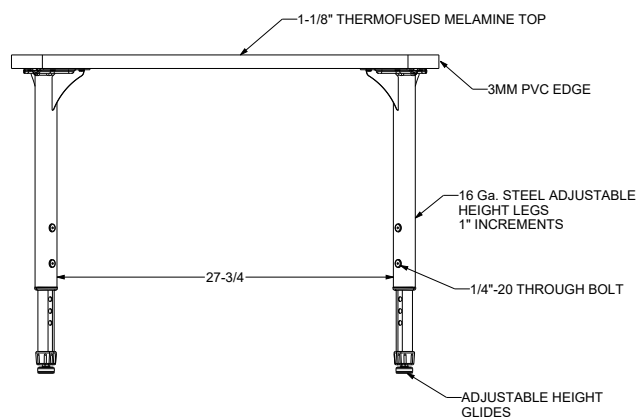
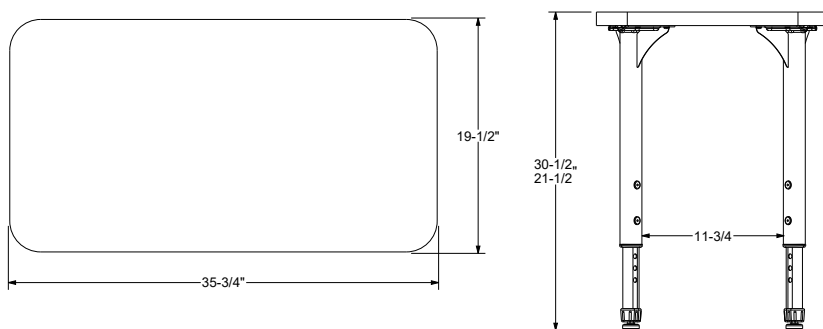

LEG SIZE OPTIONS

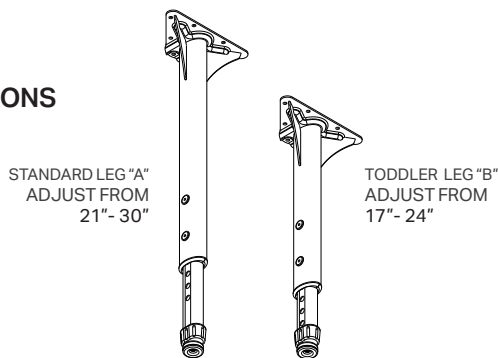

WARRANTY

10 Year Limited

CERTIFICATIONS

Worksurfaces are UL Greenguard Gold certified

This specification information is provided for general reference only and is subject to change without notice. While every effort has been made to ensure accuracy, Marco makes no warranties, express or implied, regarding the completeness or correctness of the details presented. Users should always verify specifications with the latest product documentation before making any purchasing decisions.

APEX™ SERIES DESK

Rectangle Desk (30" x 20")

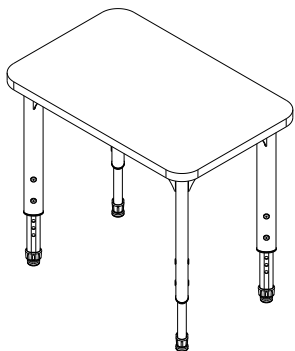

CONSTRUCTION

- Top constructed of 1-1/8" particleboard with thermally fused melamine surface on both sides
- Thermally fused 3mm PVC edge banding
- Pre-drilled holes for easy leg assembly
- Four 16-gauge steel legs mounted on a 12-gauge steel plate, fully coated with powder coat finish
- Lower legs constructed of 16-gauge steel with powder coat finish, tapped at 1" intervals for adjustment
- Nickel plated nylon swivel glides standard

FINISHES

LAMINATES Available with matching or colored edge band



DRY ERASE LAMINATES Available with colored edge band

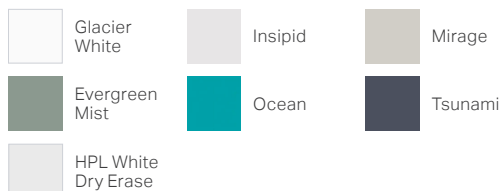

OPTIONAL EDGE BAND COLORS

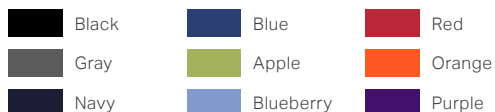

METAL FRAME OPTIONS



DIMENSIONS

Model #	Width	Depth	Height	Weight	Freight Cts
38-2223-Axxx	30"	20"	21" - 30"	45 lbs	92.5
38-2223-Bxxx	30"	20"	17" - 24"	40 lbs	92.5

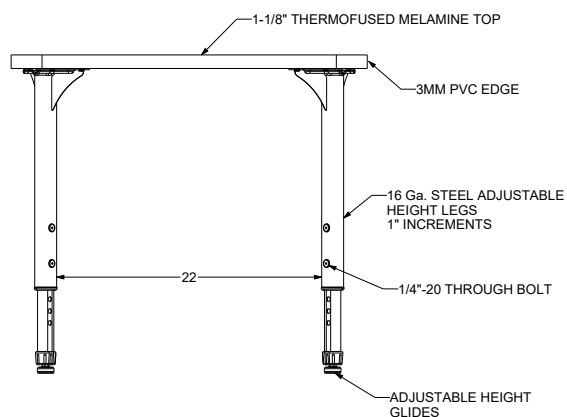
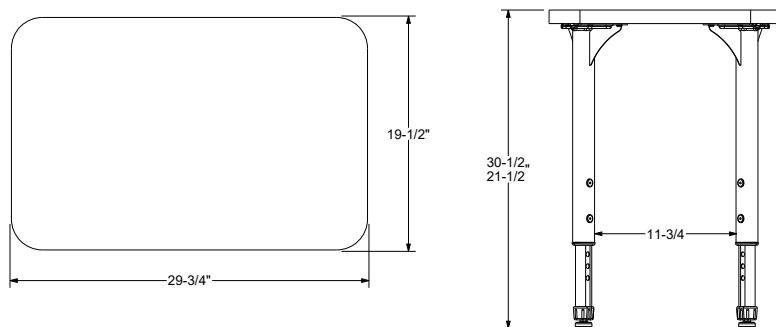

LEG SIZE OPTIONS

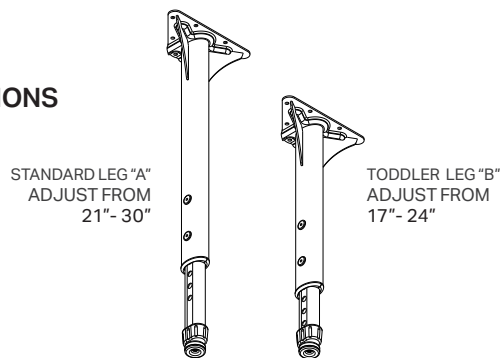

WARRANTY

10 Year Limited

CERTIFICATIONS

Worksurfaces are UL Greenguard Gold certified

This specification information is provided for general reference only and is subject to change without notice. While every effort has been made to ensure accuracy, Marco makes no warranties, express or implied, regarding the completeness or correctness of the details presented. Users should always verify specifications with the latest product documentation before making any purchasing decisions.



MARCO™

Specification Sheet

APEX™ SERIES DESK

Rectangle Desk (36"x 24")

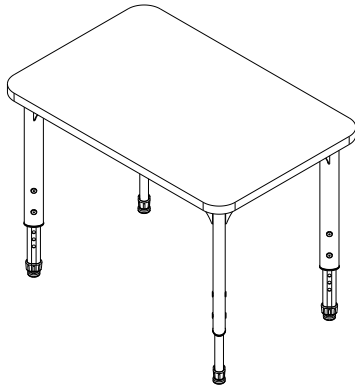

CONSTRUCTION

- Top constructed of 1-1/8" particleboard with thermally fused melamine surface on both sides
- Thermally fused 3mm PVC edge banding
- Pre-drilled holes for easy leg assembly
- Four 16-gauge steel legs mounted on a 12-gauge steel plate, fully coated with powder coat finish
- Lower legs constructed of 16-gauge steel with powder coat finish, tapped at 1" intervals for adjustment
- Nickel plated nylon swivel glides standard

FINISHES

LAMINATES Available with matching or colored edge band



DRY ERASE LAMINATES Available with colored edge band

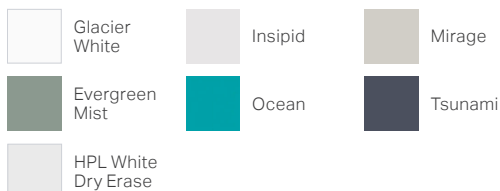

OPTIONAL EDGE BAND COLORS

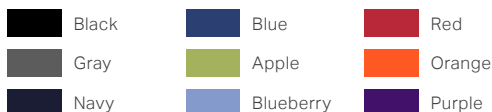

METAL FRAME OPTIONS



DIMENSIONS

Model #	Width	Depth	Height	Weight	Freight Cts
38-2224-Axxx	36"	24"	21"- 30"	54 lbs	100
38-2224-Bxxx	36"	24"	17"- 24"	49 lbs	100

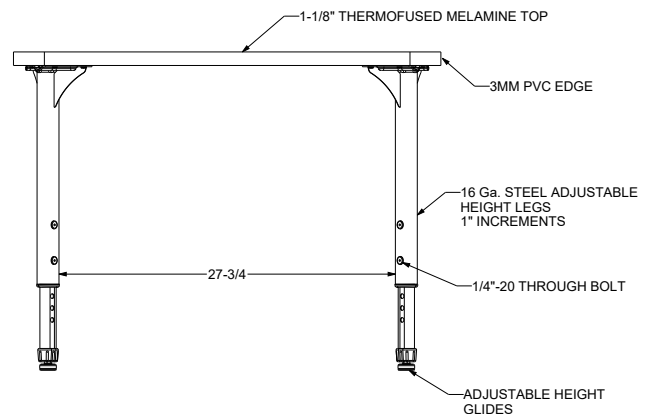
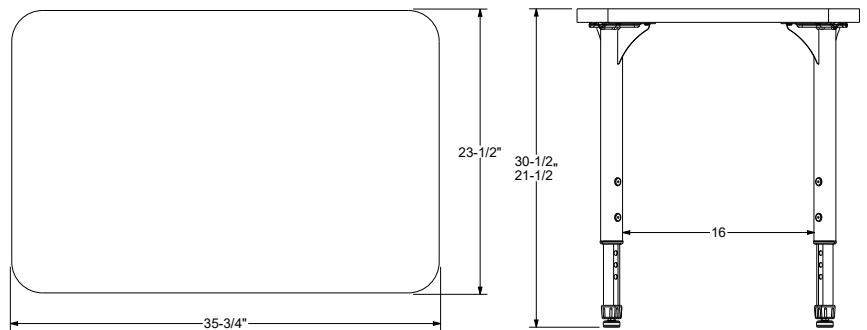

LEG SIZE OPTIONS

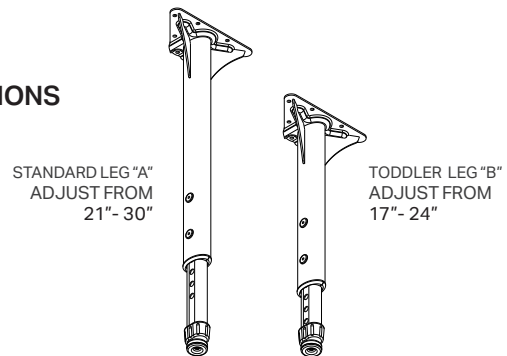

WARRANTY

10 Year Limited

CERTIFICATIONS

Worksurfaces are UL Greenguard Gold certified

This specification information is provided for general reference only and is subject to change without notice. While every effort has been made to ensure accuracy, Marco makes no warranties, express or implied, regarding the completeness or correctness of the details presented. Users should always verify specifications with the latest product documentation before making any purchasing decisions.

APEX™ SERIES DESK

Rectangle Desk (30"x 24")

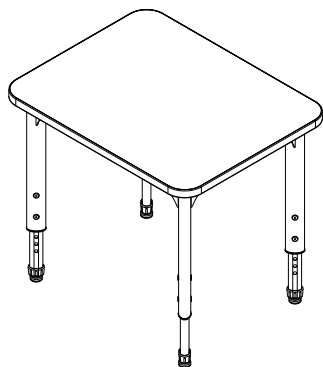

CONSTRUCTION

- Top constructed of 1-1/8" particleboard with thermally fused melamine surface on both sides
- Thermally fused 3mm PVC edge banding
- Pre-drilled holes for easy leg assembly
- Four 16-gauge steel legs mounted on a 12-gauge steel plate, fully coated with powder coat finish
- Lower legs constructed of 16-gauge steel with powder coat finish, tapped at 1" intervals for adjustment
- Nickel plated nylon swivel glides standard

FINISHES

LAMINATES Available with matching or colored edge band



DRY ERASE LAMINATES Available with colored edge band

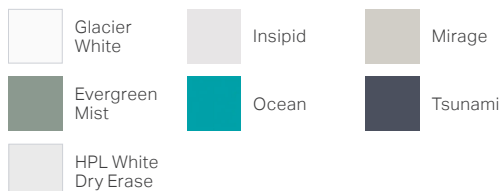

OPTIONAL EDGE BAND COLORS

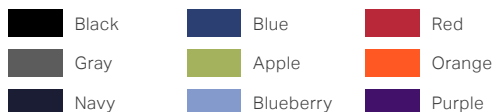

METAL FRAME OPTIONS



DIMENSIONS

Model #	Width	Depth	Height	Weight	Freight Cts
38-2229-Axxx	30"	24"	21" - 30"	48 lbs	92.5
38-2229-Bxxx	30"	24"	17" - 24"	43 lbs	92.5

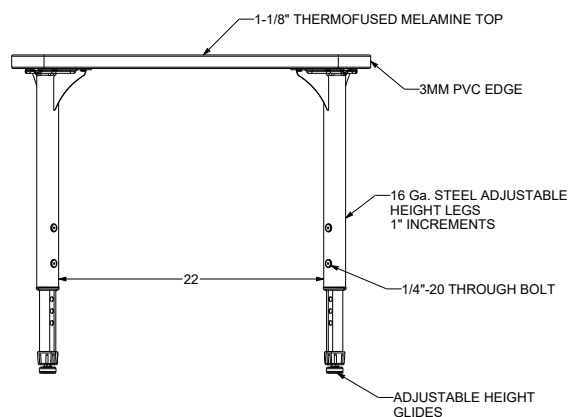
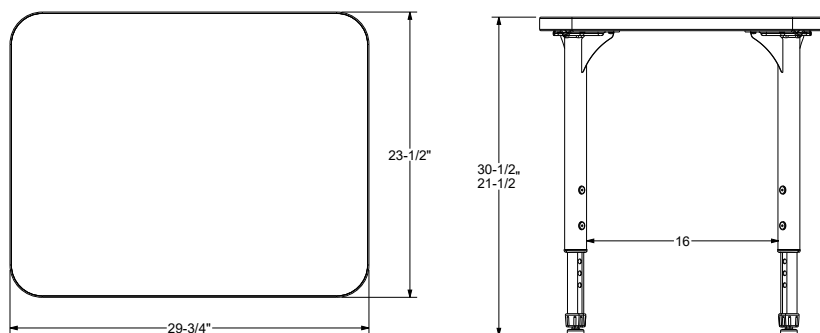

LEG SIZE OPTIONS

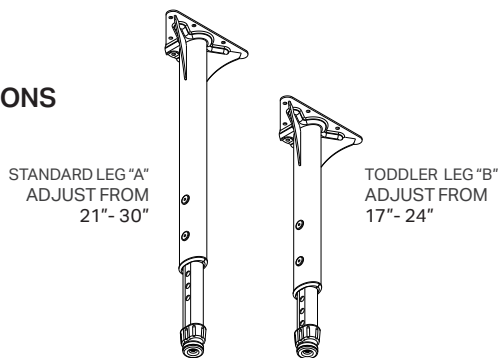

WARRANTY

10 Year Limited

CERTIFICATIONS

Worksurfaces are UL Greenguard Gold certified

This specification information is provided for general reference only and is subject to change without notice. While every effort has been made to ensure accuracy, Marco makes no warranties, express or implied, regarding the completeness or correctness of the details presented. Users should always verify specifications with the latest product documentation before making any purchasing decisions.

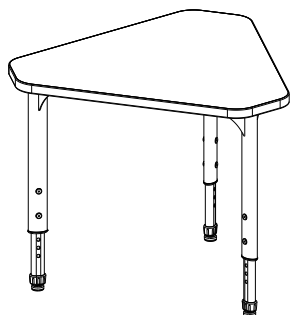

CONSTRUCTION

- Top constructed of 1-1/8" particleboard with thermally fused melamine surface on both sides
- Thermally fused 3mm PVC edge banding
- Pre-drilled holes for easy leg assembly
- Four 16-gauge steel legs mounted on a 12-gauge steel plate, fully coated with powder coat finish
- Lower legs constructed of 16-gauge steel with powder coat finish, tapped at 1" intervals for adjustment
- Nickel plated nylon swivel glides standard

FINISHES

LAMINATES Available with matching or colored edge band



DRY ERASE LAMINATES Available with colored edge band

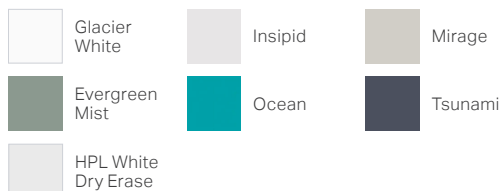

OPTIONAL EDGE BAND COLORS

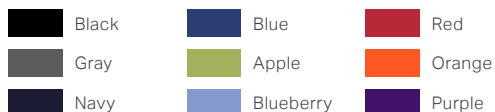

METAL FRAME OPTIONS



DIMENSIONS

Model #	Width	Depth	Height	Weight	Freight Cts
38-2271-Axxx	29.75"	33.5"	21" - 30"	34 lbs	125
38-2271-Bxxx	29.75"	33.5"	17" - 24"	29 lbs	125

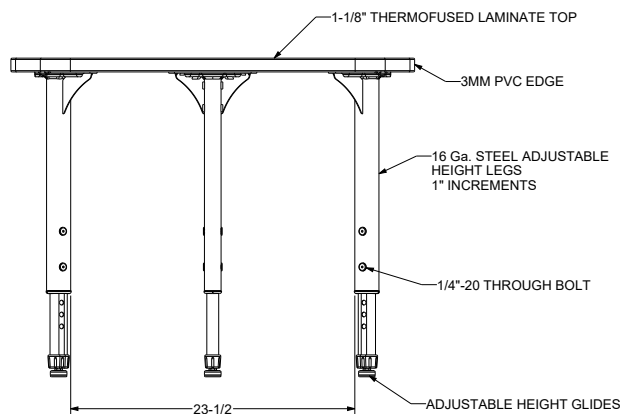
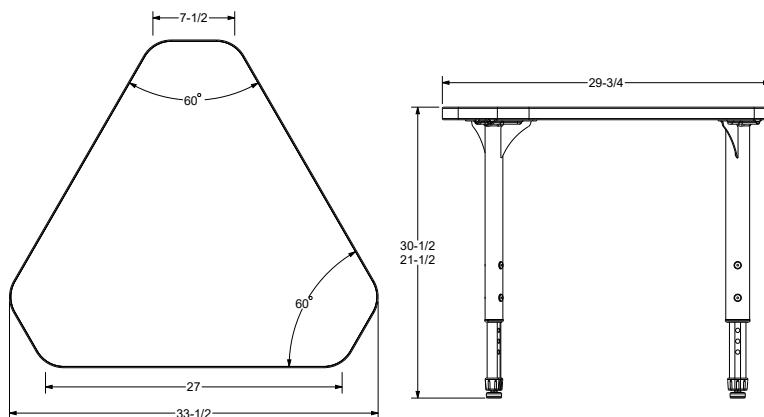

LEG SIZE OPTIONS

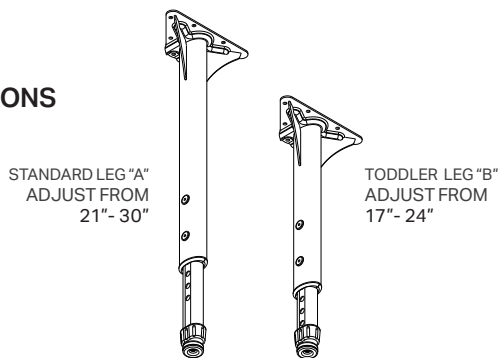

WARRANTY

10 Year Limited

CERTIFICATIONS

Worksurfaces are UL Greenguard Gold certified

This specification information is provided for general reference only and is subject to change without notice. While every effort has been made to ensure accuracy, Marco makes no warranties, express or implied, regarding the completeness or correctness of the details presented. Users should always verify specifications with the latest product documentation before making any purchasing decisions.

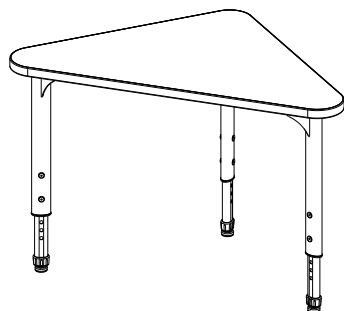

CONSTRUCTION

- Top constructed of 1-1/8" particleboard with thermally fused melamine surface on both sides
- Thermally fused 3mm PVC edge banding
- Pre-drilled holes for easy leg assembly
- Four 16-gauge steel legs mounted on a 12-gauge steel plate, fully coated with powder coat finish
- Lower legs constructed of 16-gauge steel with powder coat finish, tapped at 1" intervals for adjustment
- Nickel plated nylon swivel glides standard

FINISHES

LAMINATES Available with matching or colored edge band



DRY ERASE LAMINATES Available with colored edge band

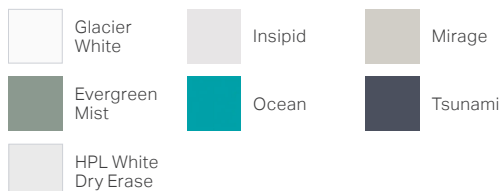

OPTIONAL EDGE BAND COLORS

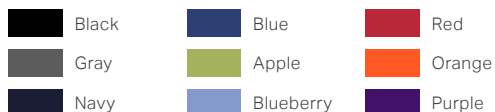

METAL FRAME OPTIONS



DIMENSIONS

Model #	Width	Depth	Height	Weight	Freight Cts
38-2272-Axxx	41"	23"	21" - 30"	34 lbs	125
38-2272-Bxxx	41"	23"	17" - 24"	30 lbs	125

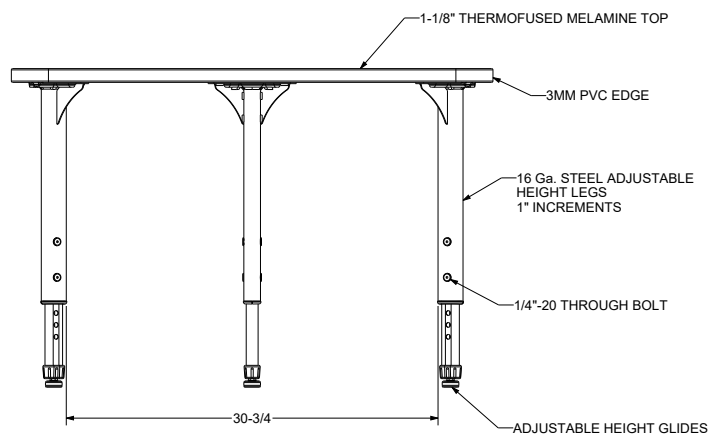
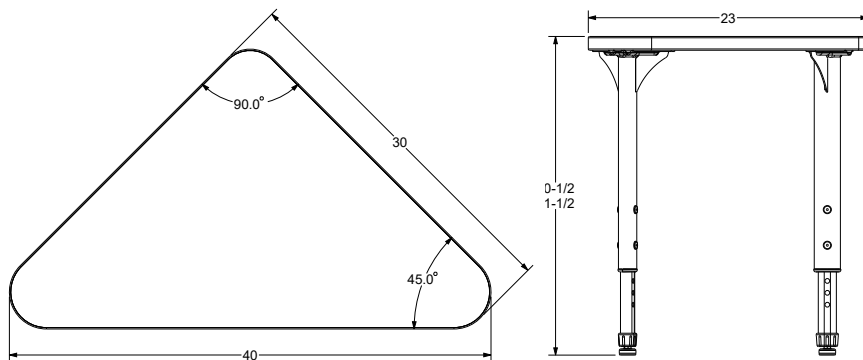

LEG SIZE OPTIONS

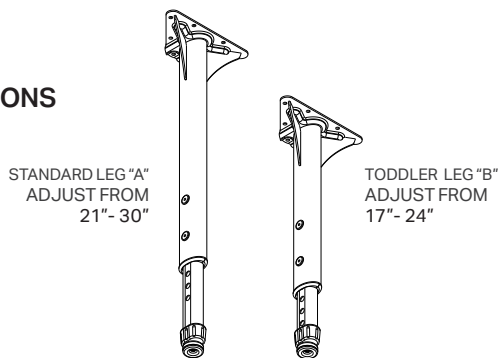

WARRANTY

10 Year Limited

CERTIFICATIONS

Worksurfaces are UL Greenguard Gold certified

This specification information is provided for general reference only and is subject to change without notice. While every effort has been made to ensure accuracy, Marco makes no warranties, express or implied, regarding the completeness or correctness of the details presented. Users should always verify specifications with the latest product documentation before making any purchasing decisions.



MARCO™

Specification Sheet

APEX™ SERIES DESK

Flare Desk

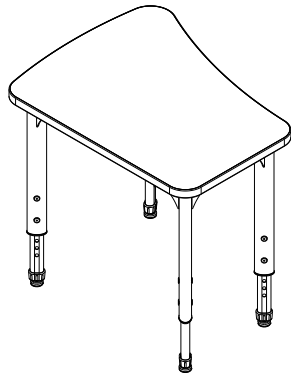

CONSTRUCTION

- Top constructed of 1-1/8" particleboard with thermally fused melamine surface on both sides
- Thermally fused 3mm PVC edge banding
- Pre-drilled holes for easy leg assembly
- Four 16-gauge steel legs mounted on a 12-gauge steel plate, fully coated with powder coat finish
- Lower legs constructed of 16-gauge steel with powder coat finish, tapped at 1" intervals for adjustment
- Nickel plated nylon swivel glides standard

FINISHES

LAMINATES Available with matching or colored edge band



DRY ERASE LAMINATES Available with colored edge band

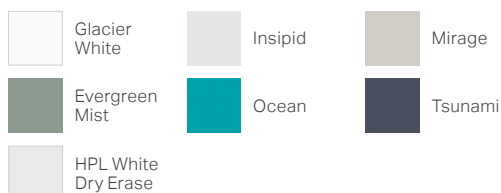

OPTIONAL EDGE BAND COLORS

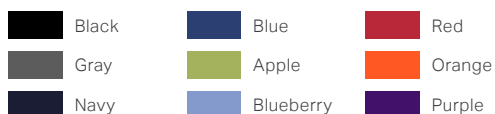

METAL FRAME OPTIONS



DIMENSIONS

Model #	Width	Depth	Height	Weight	Freight Cts
38-2274-Axxx	30"	24"	21"- 30"	46 lbs	125
38-2274-Bxxx	30"	24"	17"- 24"	41 lbs	125

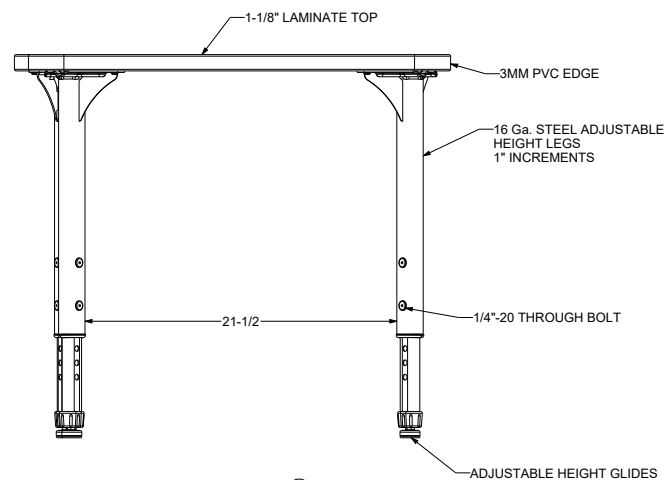
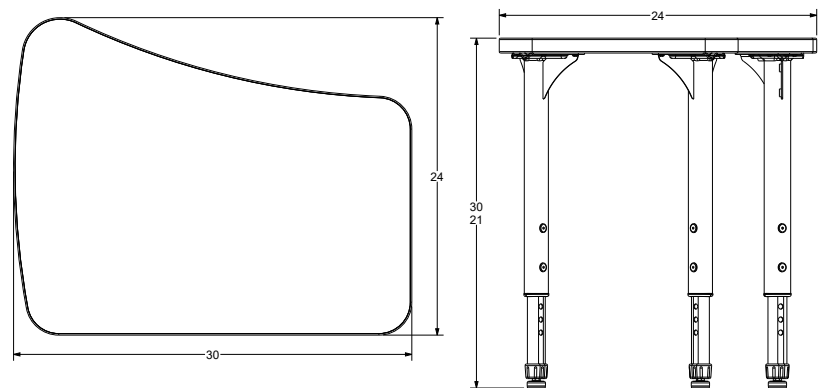

LEG SIZE OPTIONS

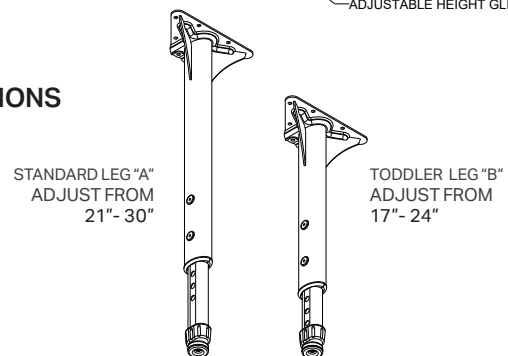

WARRANTY

10 Year Limited

CERTIFICATIONS

Worksurfaces are UL Greenguard Gold certified

This specification information is provided for general reference only and is subject to change without notice. While every effort has been made to ensure accuracy, Marco makes no warranties, express or implied, regarding the completeness or correctness of the details presented. Users should always verify specifications with the latest product documentation before making any purchasing decisions.

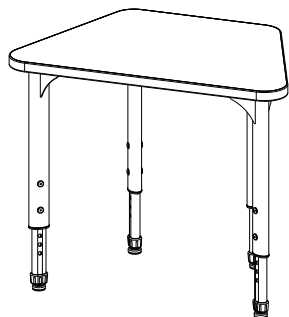

CONSTRUCTION

- Top constructed of 1-1/8" particleboard with thermally fused melamine surface on both sides
- Thermally fused 3mm PVC edge banding
- Pre-drilled holes for easy leg assembly
- Four 16-gauge steel legs mounted on a 12-gauge steel plate, fully coated with powder coat finish
- Lower legs constructed of 16-gauge steel with powder coat finish, tapped at 1" intervals for adjustment
- Nickel plated nylon swivel glides standard

FINISHES

LAMINATES Available with matching or colored edge band



DRY ERASE LAMINATES Available with colored edge band

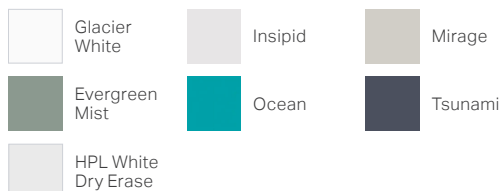

OPTIONAL EDGE BAND COLORS

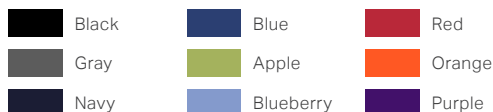

METAL FRAME OPTIONS



DIMENSIONS

Model #	Width	Depth	Height	Weight	Freight Cts
38-2283-Axxx	31"	20"	21" - 30"	36 lbs	125
38-2283-Bxxx	31"	20"	17" - 24"	31 lbs	125

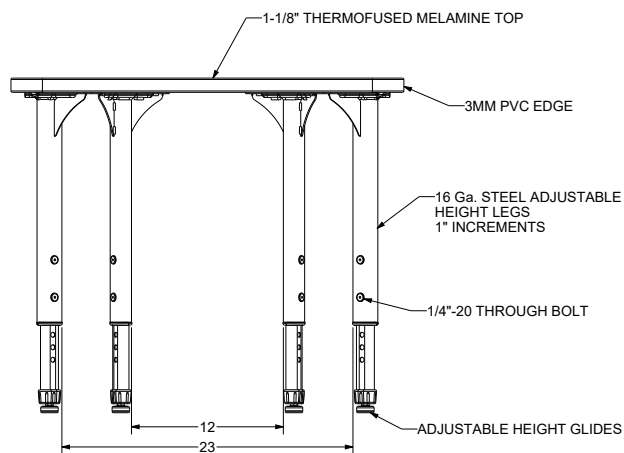
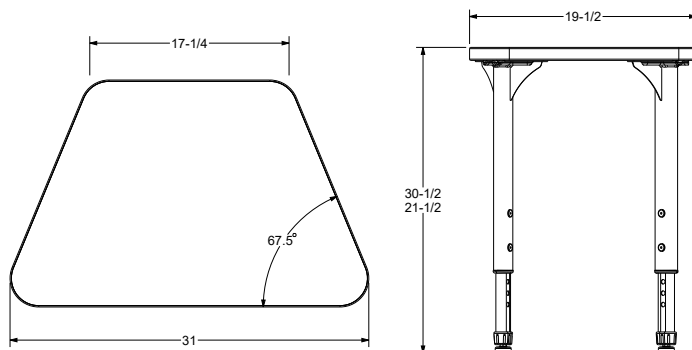

LEG SIZE OPTIONS

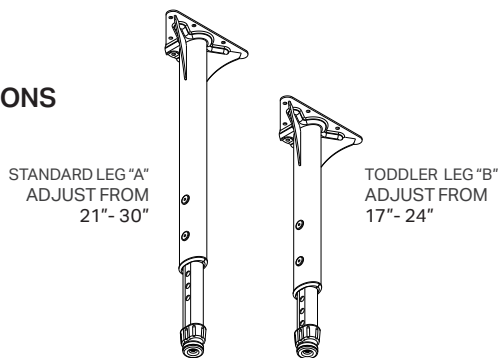

WARRANTY

10 Year Limited

CERTIFICATIONS

Worksurfaces are UL Greenguard Gold certified

This specification information is provided for general reference only and is subject to change without notice. While every effort has been made to ensure accuracy, Marco makes no warranties, express or implied, regarding the completeness or correctness of the details presented. Users should always verify specifications with the latest product documentation before making any purchasing decisions.



MARCO™

Specification Sheet

APEX™ SERIES DESK

Trapezoid Desk

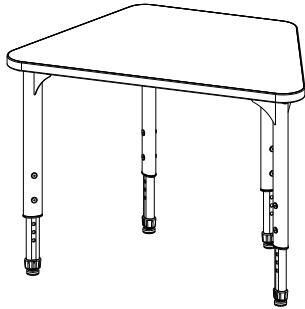

CONSTRUCTION

- Top constructed of 1-1/8" particleboard with thermally fused melamine surface on both sides
- Thermally fused 3mm PVC edge banding
- Pre-drilled holes for easy leg assembly
- Four 16-gauge steel legs mounted on a 12-gauge steel plate, fully coated with powder coat finish
- Lower legs constructed of 16-gauge steel with powder coat finish, tapped at 1" intervals for adjustment
- Nickel plated nylon swivel glides standard

FINISHES

LAMINATES Available with matching or colored edge band



DRY ERASE LAMINATES Available with colored edge band

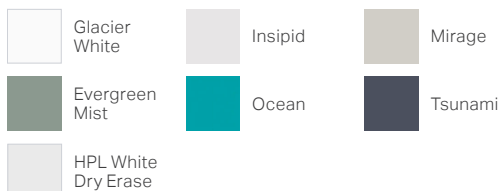

OPTIONAL EDGE BAND COLORS

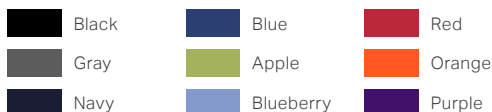

METAL FRAME OPTIONS



DIMENSIONS

Model #	Width	Depth	Height	Weight	Freight Cts
38-2284-Axxx	36"	23"	21" - 30"	39 lbs	125
38-2284-Bxxx	36"	23"	17" - 24"	34 lbs	125

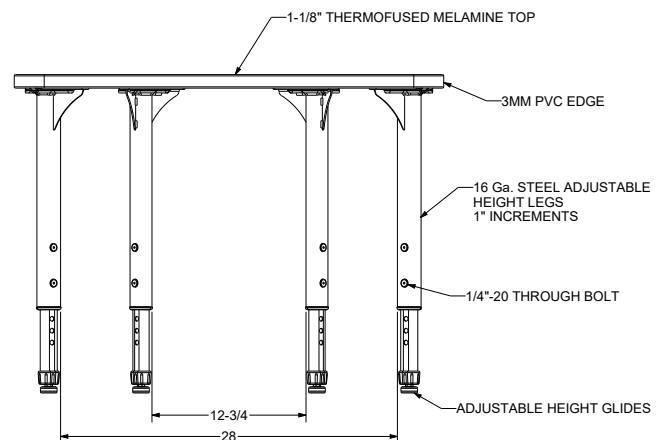
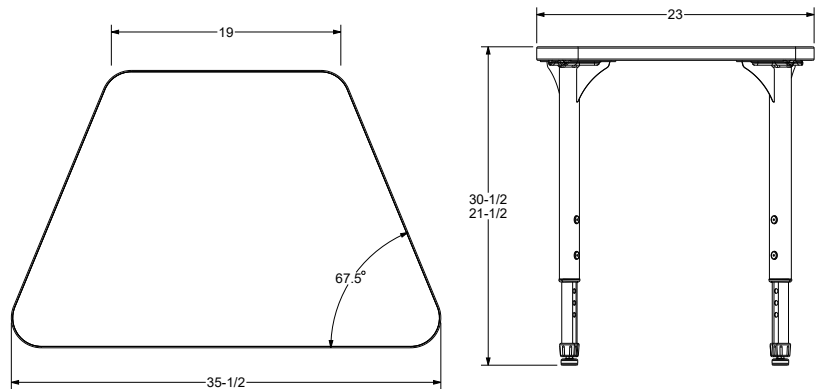

LEG SIZE OPTIONS

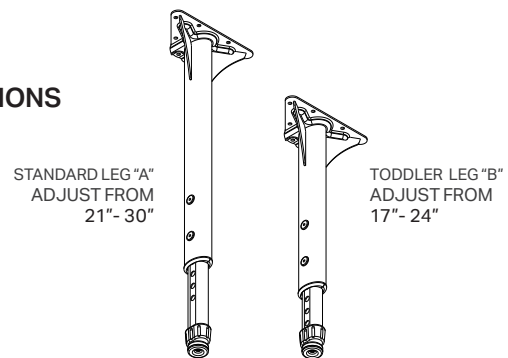

WARRANTY

10 Year Limited

CERTIFICATIONS

Worksurfaces are UL Greenguard Gold certified

This specification information is provided for general reference only and is subject to change without notice. While every effort has been made to ensure accuracy, Marco makes no warranties, express or implied, regarding the completeness or correctness of the details presented. Users should always verify specifications with the latest product documentation before making any purchasing decisions.



MARCO™

Specification Sheet

APEX™ SERIES DESK

Chevron Desk

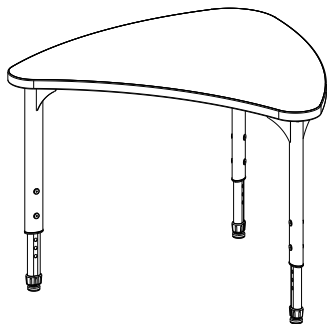

CONSTRUCTION

- Top constructed of 1-1/8" particleboard with thermally fused melamine surface on both sides
- Thermally fused 3mm PVC edge banding
- Pre-drilled holes for easy leg assembly
- Four 16-gauge steel legs mounted on a 12-gauge steel plate, fully coated with powder coat finish
- Lower legs constructed of 16-gauge steel with powder coat finish, tapped at 1" intervals for adjustment
- Nickel plated nylon swivel glides standard

FINISHES

LAMINATES Available with matching or colored edge band



DRY ERASE LAMINATES Available with colored edge band

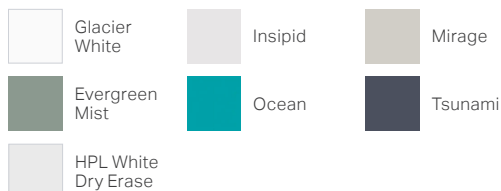

OPTIONAL EDGE BAND COLORS

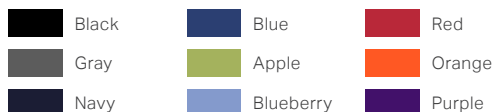

METAL FRAME OPTIONS



DIMENSIONS

Model #	Width	Depth	Height	Weight	Freight Cts
38-2290-Axxx	38"	31"	21"- 30"	44 lbs	125
38-2290-Bxxx	38"	31"	17"- 24"	39 lbs	125

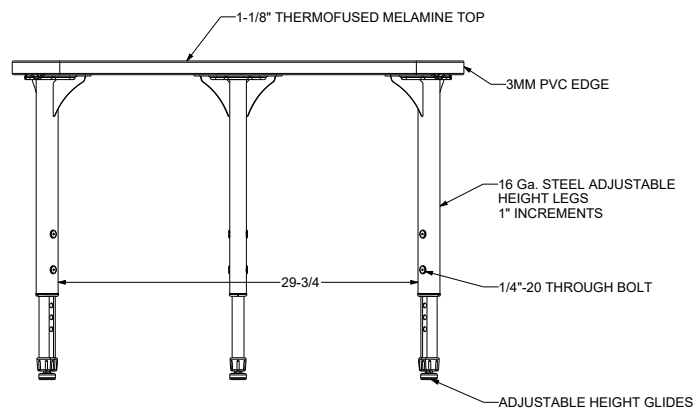
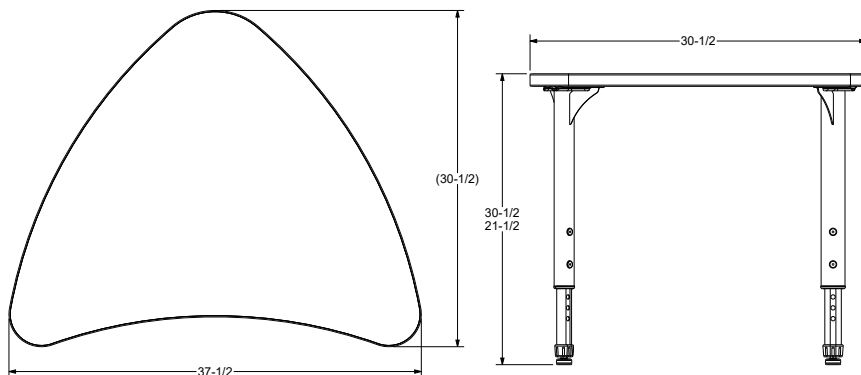

LEG SIZE OPTIONS

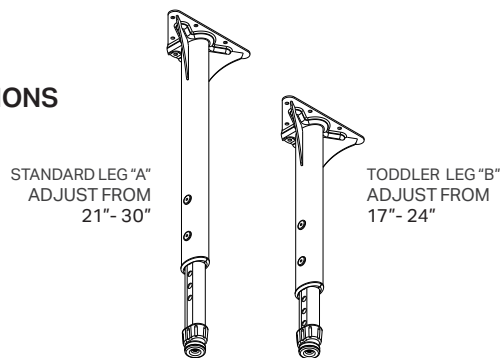

WARRANTY

10 Year Limited

CERTIFICATIONS

Worksurfaces are UL Greenguard Gold certified

This specification information is provided for general reference only and is subject to change without notice. While every effort has been made to ensure accuracy, Marco makes no warranties, express or implied, regarding the completeness or correctness of the details presented. Users should always verify specifications with the latest product documentation before making any purchasing decisions.

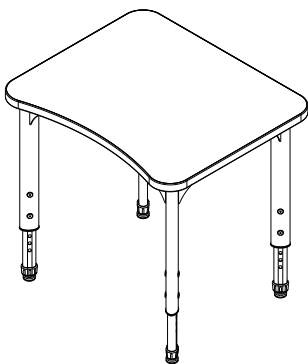

CONSTRUCTION

- Top constructed of 1-1/8" particleboard with thermally fused melamine surface on both sides
- Thermally fused 3mm PVC edge banding
- Pre-drilled holes for easy leg assembly
- Four 16-gauge steel legs mounted on a 12-gauge steel plate, fully coated with powder coat finish
- Lower legs constructed of 16-gauge steel with powder coat finish, tapped at 1" intervals for adjustment
- Nickel plated nylon swivel glides standard

FINISHES

LAMINATES Available with matching or colored edge band



DRY ERASE LAMINATES Available with colored edge band

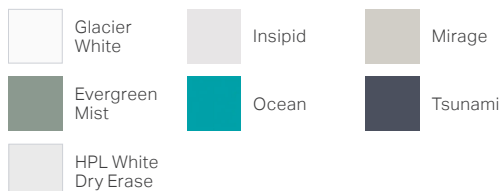

OPTIONAL EDGE BAND COLORS

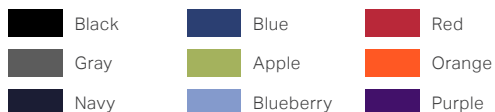

METAL FRAME OPTIONS

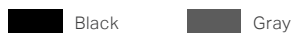

DIMENSIONS

Model #	Width	Depth	Height	Weight	Freight Cts
38-2291-Axxx	28"	24"	21" - 30"	38 lbs	100
38-2291-Bxxx	28"	24"	17" - 24"	33 lbs	100

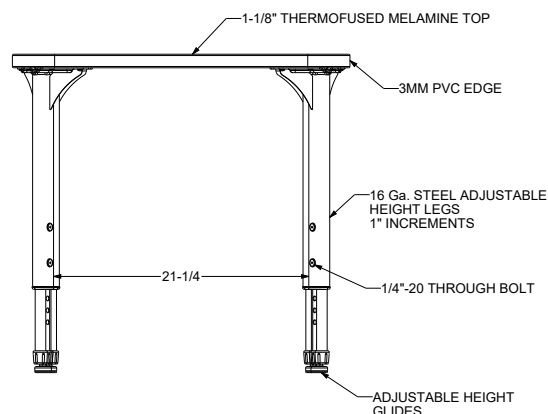
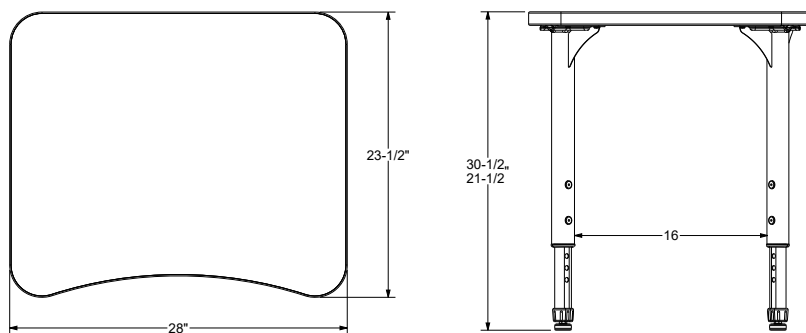

LEG SIZE OPTIONS

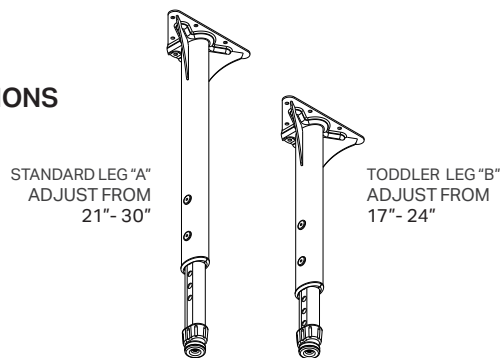

WARRANTY

10 Year Limited

CERTIFICATIONS

Worksurfaces are UL Greenguard Gold certified

This specification information is provided for general reference only and is subject to change without notice. While every effort has been made to ensure accuracy, Marco makes no warranties, express or implied, regarding the completeness or correctness of the details presented. Users should always verify specifications with the latest product documentation before making any purchasing decisions.

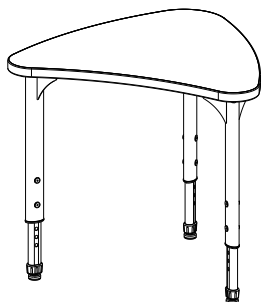

CONSTRUCTION

- Top constructed of 1-1/8" particleboard with thermally fused melamine surface on both sides
- Thermally fused 3mm PVC edge banding
- Pre-drilled holes for easy leg assembly
- Four 16-gauge steel legs mounted on a 12-gauge steel plate, fully coated with powder coat finish
- Lower legs constructed of 16-gauge steel with powder coat finish, tapped at 1" intervals for adjustment
- Nickel plated nylon swivel glides standard

FINISHES

LAMINATES Available with matching or colored edge band



DRY ERASE LAMINATES Available with colored edge band

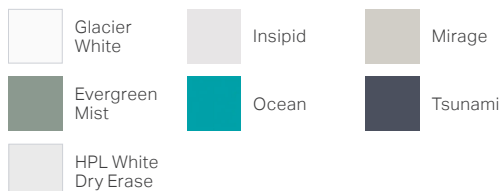

OPTIONAL EDGE BAND COLORS

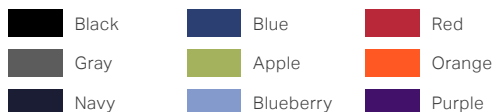

METAL FRAME OPTIONS



DIMENSIONS

Model #	Width	Depth	Height	Weight	Freight Cts
38-2292-Axxx	30"	25"	21"– 30"	35 lbs	100
38-2292-Bxxx	30"	25"	17"– 24"	30 lbs	100

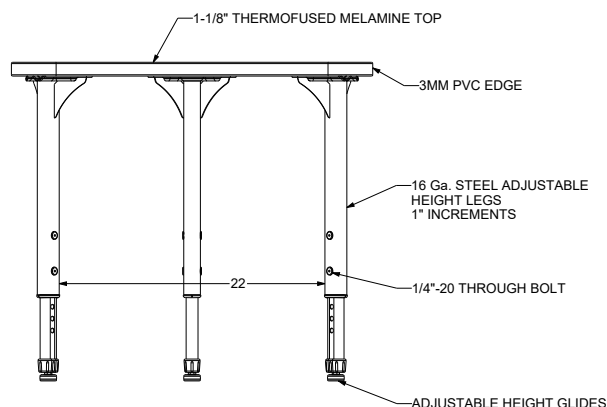
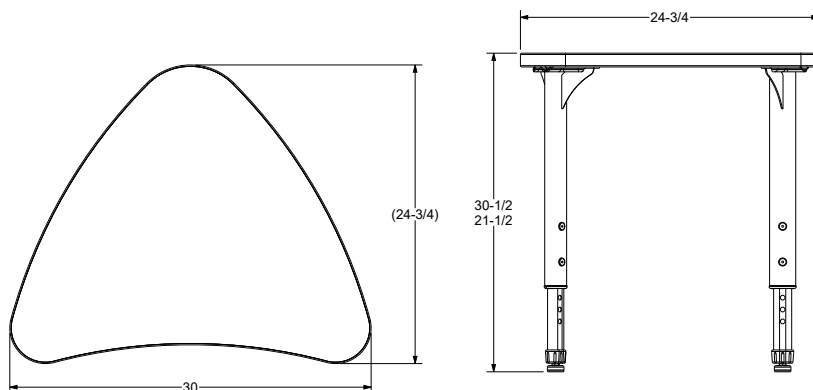

LEG SIZE OPTIONS

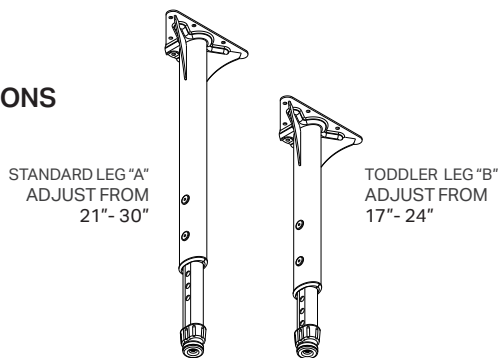

WARRANTY

10 Year Limited

CERTIFICATIONS

Worksurfaces are UL Greenguard Gold certified

This specification information is provided for general reference only and is subject to change without notice. While every effort has been made to ensure accuracy, Marco makes no warranties, express or implied, regarding the completeness or correctness of the details presented. Users should always verify specifications with the latest product documentation before making any purchasing decisions.

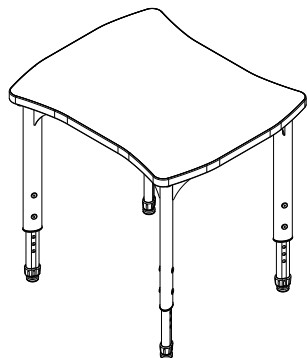

CONSTRUCTION

- Top constructed of 1-1/8" particleboard with thermally fused melamine surface on both sides
- Thermally fused 3mm PVC edge banding
- Pre-drilled holes for easy leg assembly
- Four 16-gauge steel legs mounted on a 12-gauge steel plate, fully coated with powder coat finish
- Lower legs constructed of 16-gauge steel with powder coat finish, tapped at 1" intervals for adjustment
- Nickel plated nylon swivel glides standard

FINISHES

LAMINATES Available with matching or colored edge band



DRY ERASE LAMINATES Available with colored edge band

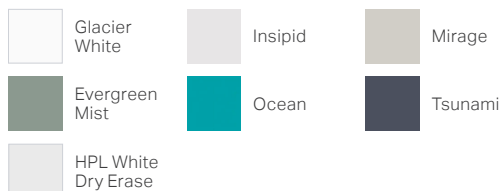

OPTIONAL EDGE BAND COLORS

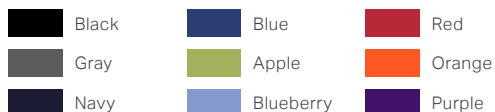

METAL FRAME OPTIONS



DIMENSIONS

Model #	Width	Depth	Height	Weight	Freight Cts
38-2310-Axxx	28"	24"	21"- 30"	32 lbs	70
38-2310-Bxxx	28"	24"	17"- 24"	28 lbs	70

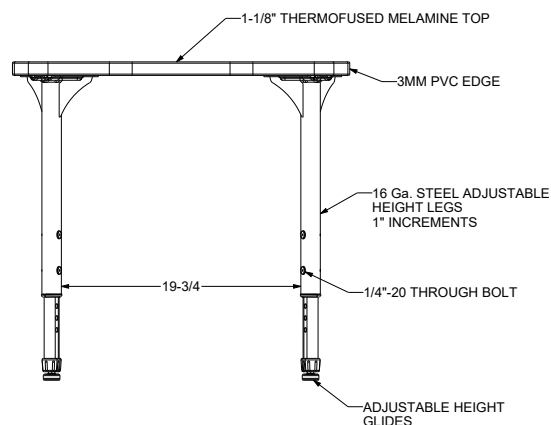
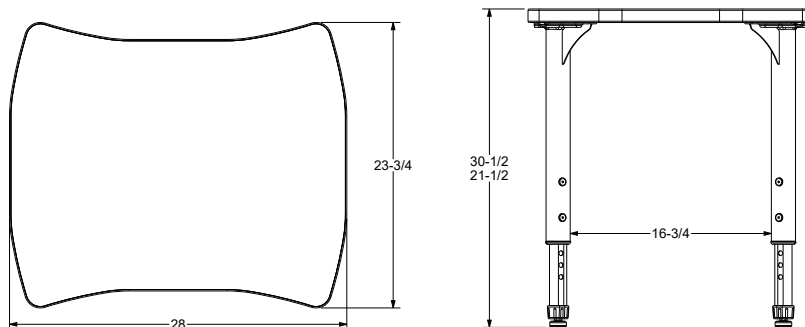

LEG SIZE OPTIONS

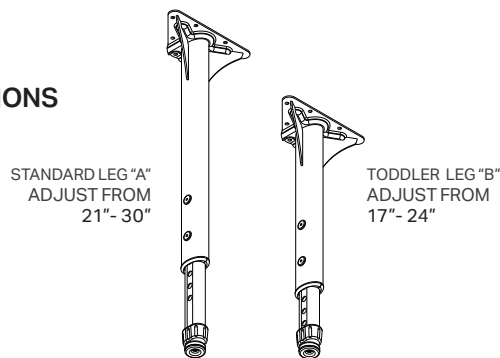

WARRANTY

10 Year Limited

CERTIFICATIONS

Worksurfaces are UL Greenguard Gold certified

This specification information is provided for general reference only and is subject to change without notice. While every effort has been made to ensure accuracy, Marco makes no warranties, express or implied, regarding the completeness or correctness of the details presented. Users should always verify specifications with the latest product documentation before making any purchasing decisions.